

2CR5 Specification

Lithium Manganese Dioxide Battery
(Li / MnO₂) 6V, 1500mAh

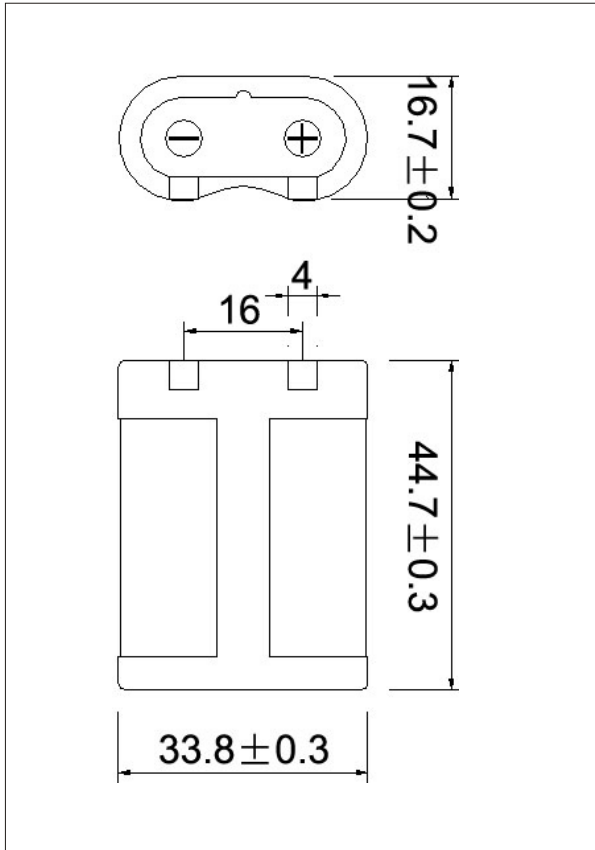

Temperature Characteristics (100mAh)

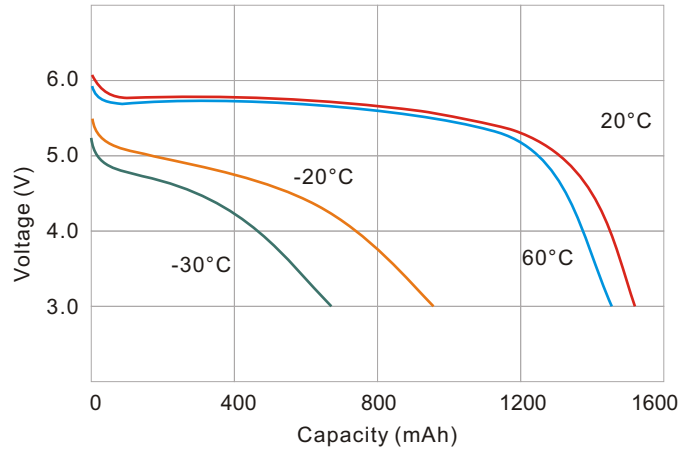

Pulse Discharge Characteristics

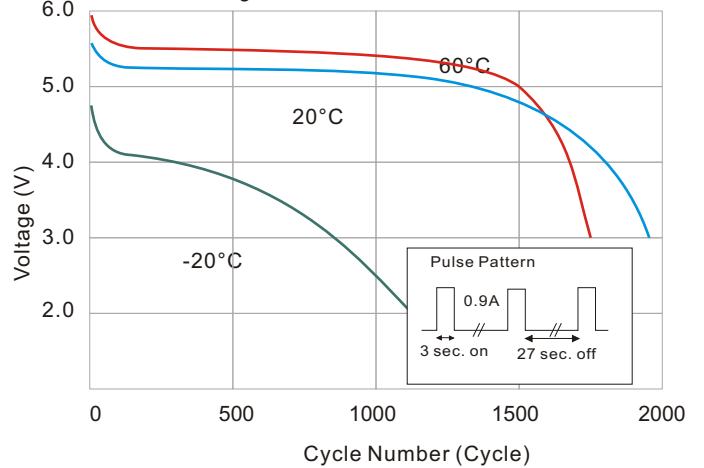

Typical Discharge Characteristics

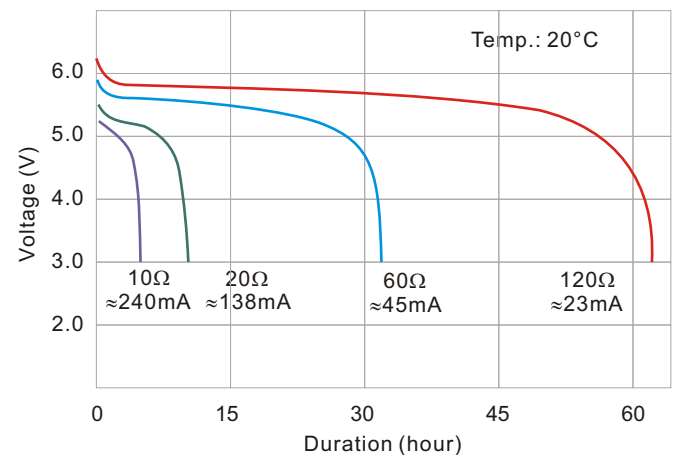

Nominal Voltage		6V
Nominal Capacity (mAh) (Base on standard drain and cutoff voltage down to 2.0V at 20°C)		1500mAh
Standard Discharge Current		45mA
Weight		36g
Maximum Dimension	Thickness	16.7±0.2mm
	Width	33.8±0.3mm
	Length	44.7±0.3mm
Max. Discharge Current	Continuous	1000mA
Operating Temperature Range		-30°C - 60°C
Cut-off Voltage		4V

**Note: The data in this document are for descriptive purposes only and subject to change without prior notice.